

REVISIONS				
NO.	DATE	DRAWN BY	CHECKED BY	DESCRIPTION

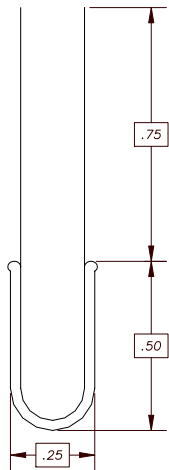
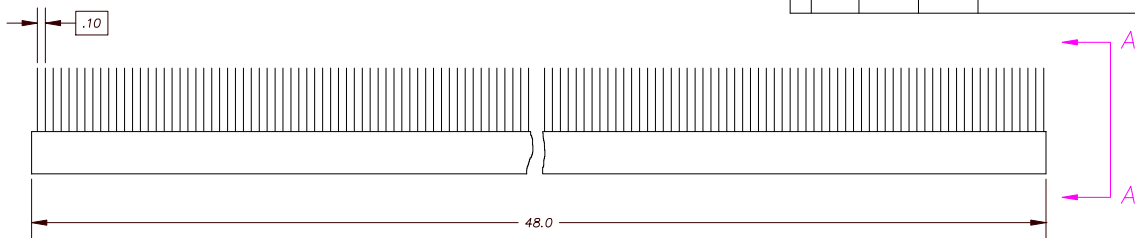

VIEW A-A
SCALE 1/4"=1"

NOTES:

- MATERIAL:
FIBER-12-275-2 STAINLESS STEEL 316L
HOLDER-ALUMINUM SHEET 300H14
- HOLE CENTERS ±.010
- HOLE DIA. ±.005
- PARTS TO BE FREE OF BURRS AND SHARP EDGES
- PARTS TO BE FREE OF OIL AND GREASE, CONTAMINANTS AND MARKINGS.
- PART TO BE ADEQUATELY PACKAGED TO PREVENT DAMAGE IN SHIPPING AND HANDLING.
- ALL PROSPECTIVE MATERIALS MUST BE SAMPLED TO AND APPROVED BY WESTMONT INC. ENGINEERING DEPT. PRIOR TO PRODUCTION START.
- DO NOT SCALE DRAWING.

Westmont Inc.		FINISH	
UNSPECIFIED TOLERANCES XX=±0.01 .XXX=±0.005		ANGLES=±0.5° HOLE DIA.=±0.005	
HOLDER AL. SHEET 3003H14		AL. MILL FIBER TYPE CARBON	
STATIC ELIMINATOR BRUSH 48" U-CHANNEL FRAME			
SCALE FULL	DATE 4/30/02	DRAWN BY J. FAGANS	CHECKED BY
SIZE B	48-1352		